

# POSITION SENSOR

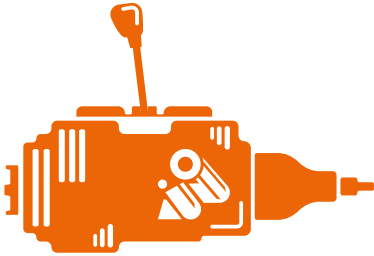

## TRANSMISSION EFFICIENCY

Optimize the equation comfort /  
pleasure / consumption

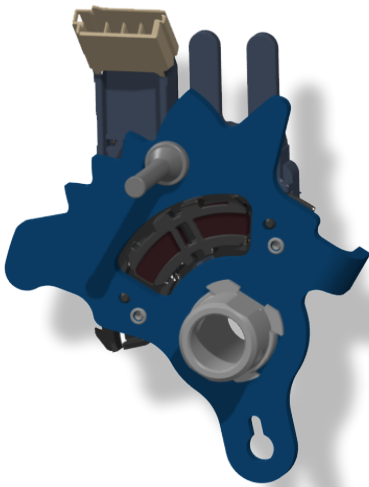

## TECHNOLOGY HALL/INDUCTIVE

EFI AUTOMOTIVE  
77, Allée des Grandes Combes  
ZI OUEST BEYNOST  
F - 01708 MIRIBEL CEDEX FRANCE  
T. +33 0(4) 72 01 34 34 - F. +33 0(4) 72 01 34 50  
WWW.EFIAUTOMOTIVE.COM

### Application description

This sensor is specially designed to be able to measure linear as well as rotary displacements.

It is a flexible measurement platform suitable for various applications:

- In manual transmissions for clutch management: it is used to monitor position of the clutch master cylinder (CMC) or the clutch slave cylinder (CSC).
- In manual transmission for gearshifter position: to detect neutral gear sensor (NGS), or all gear position sensor (AGS).
- In Dual clutch transmission (DCT): it monitor the fork position for ever more responsive, accurate and reliable gears changes.
- In Automatic transmission (AT): it detects the selected mode of the transmission (transmission range sensor, TRS - Internal mode switch, IMS - Inhibitor switch INHSW).

This multi-purpose sensor can be used as position sensor for many functions in the powertrain, chassis or cockpit area which required accurate and stray field immune position measurement.

- Intake manifold actuator position sensor
- Automatic transmission actuator position sensor
- Chassis actuator sensor
- Variable compression ratio actuator position sensor
- Vehicle level sensor (VLS)
- Steering position sensor
- Seat position sensor

### Technical characteristics

- Rotary and Linear Absolute Position Sensor.
- Programmable output transfer function linearization functionality, that provides high output accuracy and linearity.
- Range selection and offset programming by either EFI Automotive or customer.
- Selectable output mode: Analog / PWM / SENT.
- Open/short on-board diagnostics and voltage protections.
- Temperature-stable, mechanical stress immune.
- 12 bit resolution.
- Wide ambient operating temperature range: -40°C to 150°C.
- Sensor tested for vibrations over 1000Hz during DV.
- Standard package for EFI Automotive worldwide process.